



SPANISH
DANCER

Gerald Cassidy



THE SANTA FE ROOM

1,275 square feet accommodates meetings for up to 120 guests, receptions for 100, or banquets for 80. On the walls of the Santa Fe Room are some of La Fonda's most cherished treasures, including original artwork by early artists such as Gerald Cassidy and Arnold Ronnebeck. With its 25 foot high cathedral ceiling, decorative tin chandeliers, carved bas-relief tiles, and wood-burning fireplace, the Santa Fe Room is the ideal venue for any meeting or event.



LA TERRAZA AND PATIO

2,295 square feet accommodates receptions for up to 225 guests, theatre style meetings for 200, or banquets for 180. Upon entering La Terraza through the expansive, hand-carved Spanish wood doors, the room greets you with beauty and light. From the stunning Italian marble floor and the hand-sculpted kiva fireplace, to the striking stained glass skylights, this impressive room is perfect for any event. The French doors fill the room with natural light and offer panoramic views of the Cathedral Basilica of Saint Francis of Assisi and the Sangre de Cristo Mountains. In addition to the meeting room, this space features a lush, seasonal garden patio that can expand your event to provide for an alfresco reception or custom tenting. The ornate fountain, crafted with hand-made talavera tile, adds to the ambiance.



THE NEW MEXICO ROOM

2,460 square feet accommodates meetings for up to 250 guests, receptions for 200, or banquets for 180. The New Mexico Room makes its grandeur known from the moment guests walk past the portal with the sculpted terracotta fireplace and enter the room. Inside, the hand-crafted tin and glass chandeliers and intricately carved beamed ceilings exude Old World charm.



THE LUMPKINS BALLROOM

6,560 square feet accommodates meetings for up to 740 guests, receptions for 700, or seated meals for 580. The Lumpkins Ballroom is our crown jewel, providing majesty and grandeur to large events. Hand-wrought chandeliers, two terracotta wood-burning fireplaces, and an extensive art collection add to the room's charm. While this ballroom is ideal for large events, the room can also be divided in half for smaller, more intimate functions.



THE BALLEN BOARDROOM

384 square feet accommodates meetings for up to 12 guests. The Ballen Board Room is named after Sam and Ethel Ballen, the former owners of La Fonda for nearly 50 years. Appointed in a contemporary fashion with Saarinen leather chairs and a hand-crafted custom board table, this room is perfect for executive board meetings. The natural lighting opens up the room and allows for creativity and productivity. This room is equipped for a full audio-visual experience as well as wireless capabilities.

The Exchange Room

490 square feet accommodates receptions up to 40 guests, and meetings and banquets for 30. This room combines a traditional tin ceiling with modern lighting, providing accommodations ideal for both meetings and events. The hand-painted windows by former resident artist, Ernest Martinez, add character and charm.

The Mezzanine

2,745 square feet accommodates receptions for 200 or seated meals for 120. The Mezzanine, located adjacent to the Lumpkins Ballroom, provides a beautiful space for registration, coffee breaks, continental breakfasts, pre-banquet receptions, pre-function space and poster sessions. The skylights provide natural lighting, enhancing the space and showcasing the murals painted by Vladan Stiha. The wrought iron sconces and hand-forged railings, allow guests to overlook the charming La Plazuela dining room below.

Stiha Room

864 square feet accommodates receptions for up to 70, theatre style meetings for up to 60, and banquets for 60 guests. This room is home to La Fonda's collection of Vladan Stiha's portraits. Located alongside the Ballroom and the Mezzanine, the Stiha Room is the ideal location for small meetings, executive retreats, and catered functions.

MEETING FACILITIES & ROOM CAPACITIES



NAME	DIMENSIONS	CEILING HT	SQ FT	THEATER	BANQUET	CLASSROOM	RECEPTION	HOLLOW SQUARE
Lumpkins Ballroom	80 x 82	16	6,560	740	580	350	700	80
Ballroom South	38 x 79	16	3,092	225	200	150	300	64
Ballroom North	38 x 79	16	2,999	225	200	150	300	64
Mezzanine (Ballroom Pre-function)	Length & Width vary on each side	8	2,745	—	120	—	200	50
New Mexico Room	41 x 60	11	2,460	250	180	140	200	50
Portal (New Mexico & Santa Fe Pre-function)	18 x 39	13	702	—	—	—	50	—
La Terraza Room	45 x 51	12	2,295	200	180	140	225	50
La Terraza Garden Patio	41 x 57	—	2,337	180	100	—	250	—
Santa Fe Room	25 x 51	20	1,275	120	80	60	100	40
Stiha Room	24 x 36	10	864	60	60	40	70	30
Exchange Room	14 x 35	8	490	30	30	25	40	20
Ballen Boardroom	12 x 32	10	384	—	—	—	—	12

TOTAL SQUARE FOOTAGE: 20,112

Capacities may vary based on audio-visual needs.

First Floor

Lobby

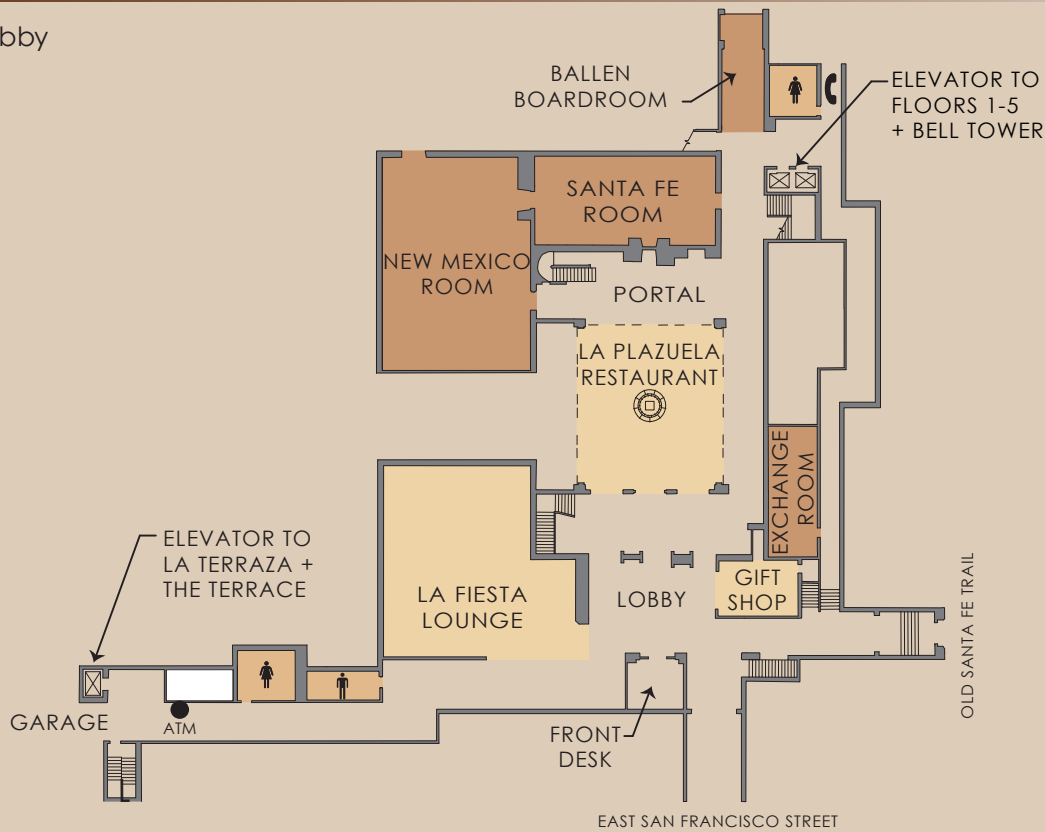

Second Floor

Mezzanine & Ballroom

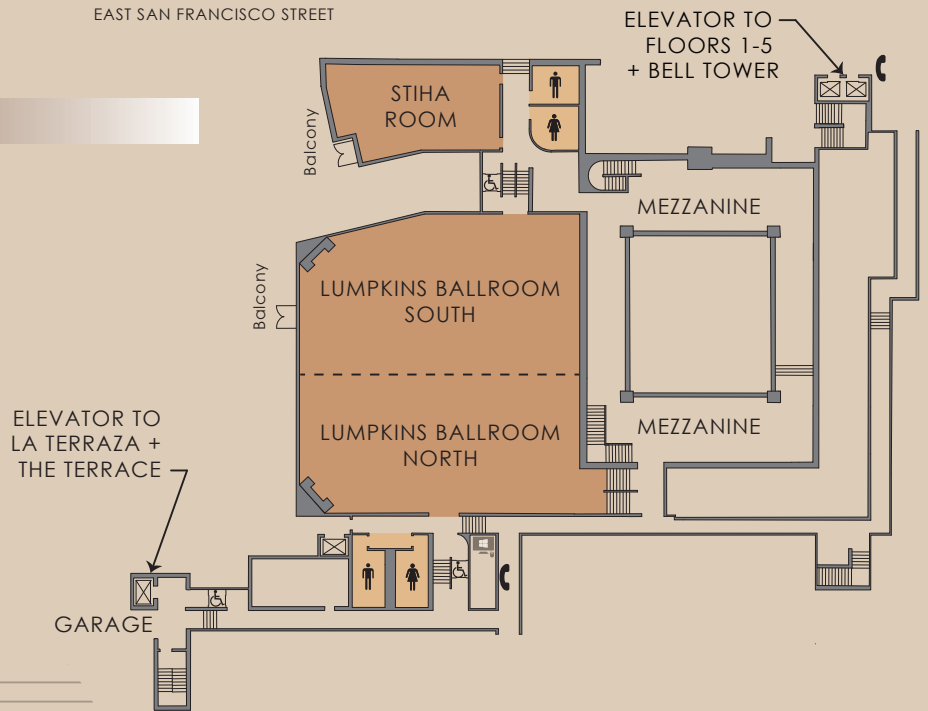

Third Floor

La Terraza



 Elevator |
  Stairs |
  Lift |
  Restrooms |
  House Phone

First Floor Meeting Facilities



100 E. San Francisco Street
Santa Fe, New Mexico 87501

NOTE: THESE PLANS FOR MEETING
ROOM SQUARE FOOTAGE SHEET -- ALL
SHEET INFORMATION NOT SHOWN.

Second Floor Meeting Facilities

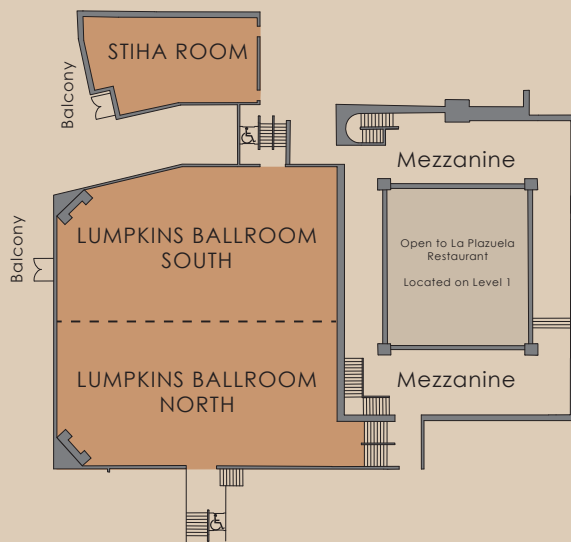

Third Floor Meeting Facilities





Where Great Minds Meet.

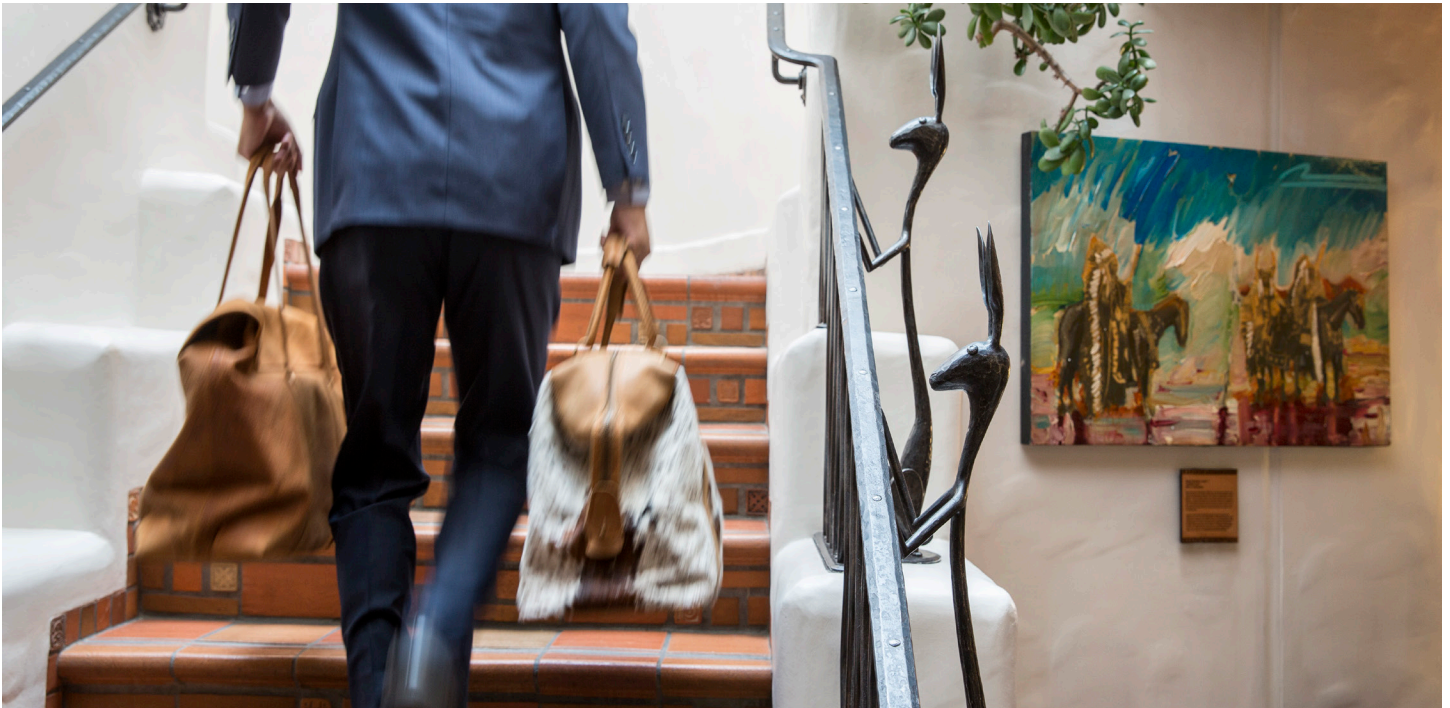

In the past 100 years, it's easy to understand why La Fonda on the Plaza inspired so many renowned artists, musicians, actors, and scientists. Here in the vibrant heart of Santa Fe, every business meeting becomes an engaging experience, surrounded by breathtaking landscapes, an electrifying art scene, and culinary delights.

Immerse yourself in La Fonda's rich tapestry of history and become part of a legacy that has fueled creativity and discovery for hundreds of years. Join us in making the next 100 years of history, and uncovering the enchantment of the Southwest at La Fonda.

Make Boring Meetings History.

Whether you're planning a corporate event or a large-scale conference, La Fonda on the Plaza has over 20,000 square feet of meeting and banquet space packed with ornate Southwestern charm and centuries of local artwork. With history literally and figuratively lining the halls, our unique guest and meeting rooms offer a serene escape to simplicity and inspiration.

For the past century, we've prided ourselves on setting the Santa Fe standard for hospitality. Whether you're hosting 50 people or 500, your group will receive the same four-diamond service and attention to detail. Our menus are imaginative, our food is delicious, and our seasoned event planners will collaborate side-by-side with you to ensure your guests experience the unique charm and warm friendliness of The Land of Enchantment.

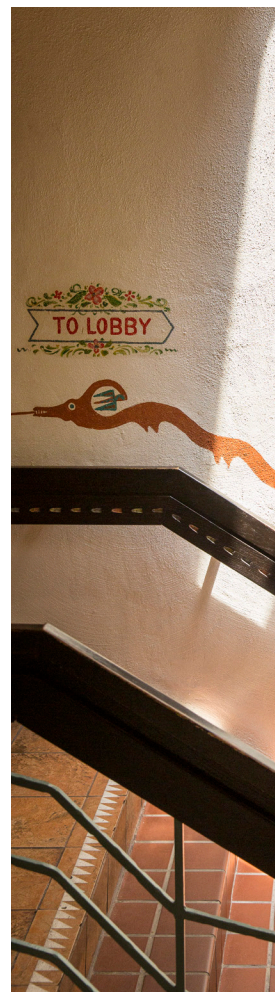



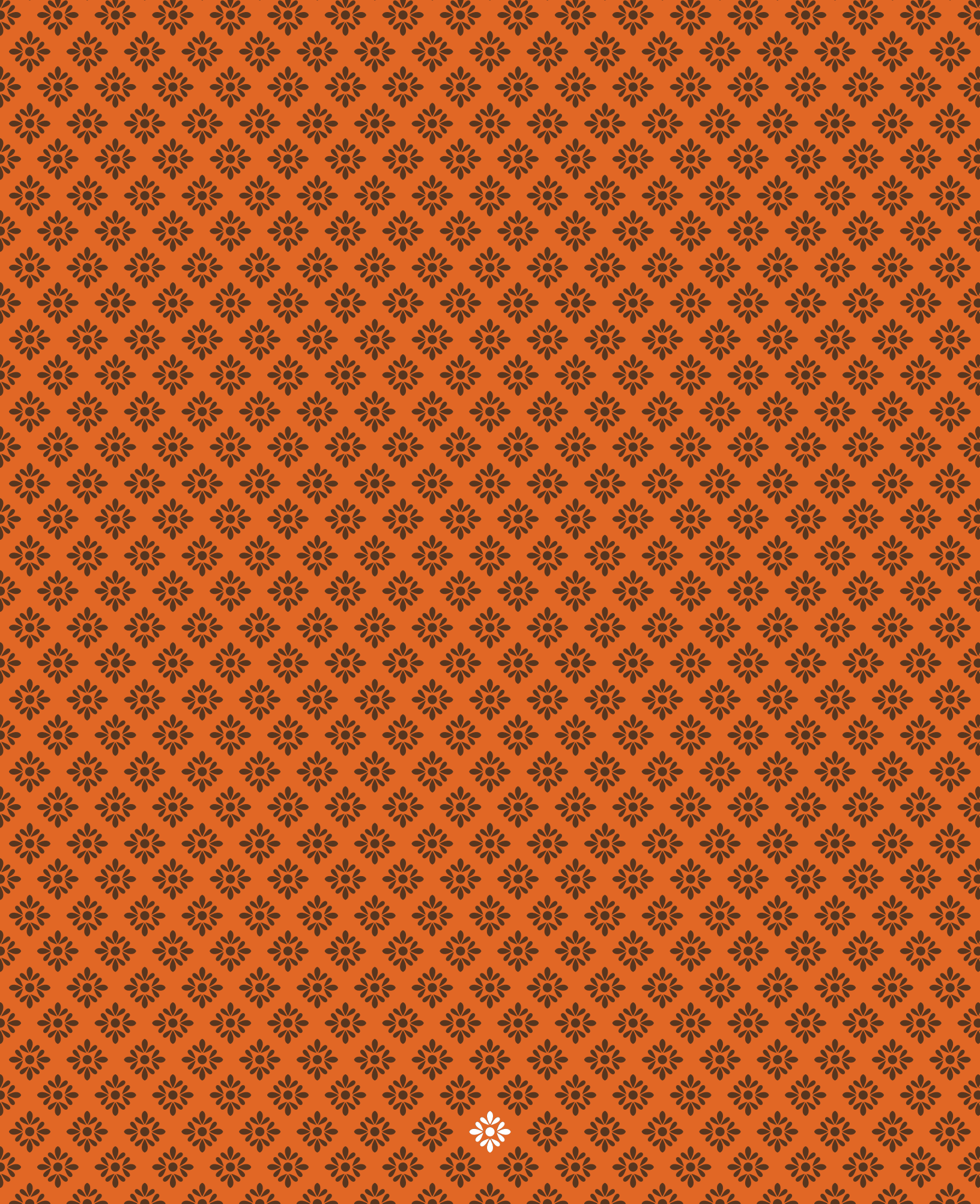

LA FONDA
❁ ON THE PLAZA ❁
100 E SAN FRANCISCO ST.
SANTA FE, NEW MEXICO | EST. 1922

LAFONDASANTAFE.COM

(505) 982 5511